

Perfecting Original Astronautic Couplings



- A-Series couplers provide convenient automatic connection and safe 'one-handed' disconnection.
- A-Series couplers have a reverse-acting sleeve to prevent accidental disconnection.
- Material and rugged design optimizes pressure performance, while ensuring corrosion resistance in most applications.
- B-Series miniature profile is ideal for installations in compact locations.
- B-Series interlocking-sleeve design prevents accidental disconnection.

Performance Specifications	Operating Bar (PSI)	Coupled Burst Bar (PSI)	Flow $\Delta P=0.4\text{Bar}$ (6.9 Bar Inlet)	Locking Mechanism
1/8" (B-Series)	10 (150)	41 (600)	3 CFM	3 Balls
1/8" (A-Series)	310 (4,500)	1,241 (18,000)	7 CFM	3 Balls
1/4" (A-Series)	207 (3,000)	828 (12,000)	25 CFM	3 Balls

Note: Burst and operating pressure values are based upon testing of a connected coupling. Contact factory for disconnected coupling values.

B-Series Astronautics Miniature (Automatic Coupler)

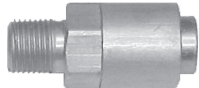

(Male Thread)

Part Number	Body Size	Thread Size	Body Material	Weight (lb)	List Price	Bag Qty	Pack Qty
1BM1-B	1/8"	1/8"-27 NPTF	brass	0.08	\$13.01	10	100

B-Series Astronautics Miniature (Nipple)

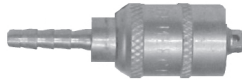

(Standard Hose Barb)

Part Number	Body Size	Barb Configuration	Body Material	Weight (lb)	List Price	Bag Qty	Pack Qty
B1S1-B	1/8"	1/8" Hose Barb	brass	0.04	\$13.96	10	100

A-Series Astronautics High Pressure (Automatic Coupler)

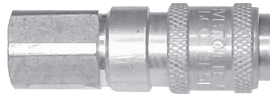

(Female Thread)

Part Number	Body Size	Thread Size	Body Material	Weight (lb)	List Price	Bag Qty	Pack Qty
1AF1-B	1/8"	1/8"-27 NPTF	brass	0.08	\$21.31	10	100
2AF1-B	1/4"	1/8"-27 NPTF	brass	0.17	22.19	10	100
2AF2-B	1/4"	1/4"-18 NPTF	brass	0.16	22.87	10	100

A-Series Astronautics High Pressure (Nipple)

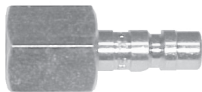

(Female Thread)

Part Number	Body Size	Thread Size	Body Material	Weight (lb)	List Price	Bag Qty	Pack Qty
A1F1	1/8"	1/8"-27 NPTF	steel	0.03	\$7.11	10	100
A1F1-B	1/8"	1/8"-27 NPTF	brass	0.03	7.52	10	100
A2F1	1/4"	1/8"-27 NPTF	steel	0.08	3.32	10	100
A2F1-B	1/4"	1/8"-27 NPTF	brass	0.08	4.56	10	100
A2F2	1/4"	1/4"-18 NPTF	steel	0.07	3.16	10	100
A2F2-B	1/4"	1/4"-18 NPTF	brass	0.07	6.75	10	100

A-Series Astronautics High Pressure (Automatic Coupler)



(Male Thread)

Part Number	Body Size	Thread Size	Body Material	Weight (lb)	List Price	Bag Qty	Pack Qty
1AM1-B	1/8"	1/8"-27 NPTF	brass	0.08	\$21.31	10	100
2AM1-B	1/4"	1/8"-27 NPTF	brass	0.17	22.19	10	100
2AM2-B	1/4"	1/4"-18 NPTF	brass	0.16	22.87	10	100